

Galanz

@2021 Galanz Americas Limited Company

Galanz

MODEL: GLDC12S110A
GRIND & BREW COFFEE MAKER USER MANUAL

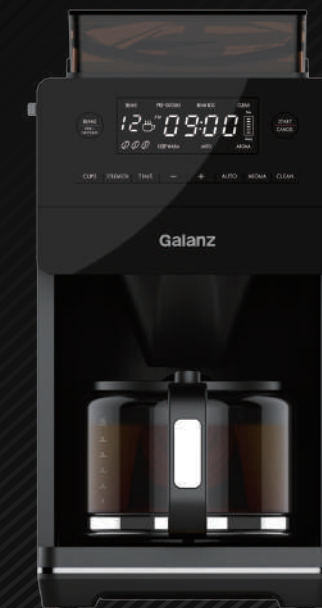

Thank you for purchasing a Galanz product. Please read this manual carefully for correct usage and safety, and keep for future reference. For service, support and warranty information, call 800-562-0738.

@2021 Galanz Americas Limited Company

CONTENTS

Important Safeguards	1
What's in the Box	3
Getting to Know Your Coffee Maker	4
Control Panel	
Function Buttons	
Before First Use	
Programming the Time	
Programming Auto Start	
Preparing & Using Your Coffee Maker	6
Brewing with Fresh Beans	
Brewing with Pre-Ground Coffee	
Status Messages	
Care & Maintenance	9
Cleaning	
Storage	
Troubleshooting Guide	10
Product Warranty	11

IMPORTANT SAFEGUARDS

When using electrical appliances, basic safety precautions should always be followed, including the following:

READ ALL INSTRUCTIONS BEFORE USING YOUR Galanz Grind & Brew Coffee Maker.

- Close supervision is necessary when any appliance is used by or near children or individuals with certain disabilities.
- To protect against electric shock, DO NOT PLACE ANY PART OF THE COFFEE MAKER IN WATER OR OTHER LIQUIDS.
- Do not operate the appliance without water in the water tank.
- Scalding may occur if the basket holder is opened during the brewing cycle.
- Do not let cord hang over edge of table or counter, or touch hot surfaces.
- Do not operate the appliance with a damaged cord, plug, after the appliance malfunctions or after it has been dropped or damaged in any manner. Please contact us at 1-800-562-0738 for troubleshooting and warranty support.
- The use of accessory attachments not recommended by Galanz may cause injuries.

- Unplug from outlet when either the appliance or display clock is not in use and before cleaning. Allow it to cool before putting on or taking off parts, and before cleaning the appliance.To unplug, grasp the plug and pull from the outlet. Never pull from the power cord.
- Do not clean with metal scouring pads. Pieces can break off the pad and touch electrical parts, posing a risk of electric shock.
- Be careful with the carafe of this appliance and never use a cracked one.
- Do not use outdoors.
- Do not use appliance for other than intended use.
- This appliance is for HOUSEHOLD USE ONLY.
- Do not touch hot surfaces. Use handles and knobs.
- This appliance can be used by persons (including children) with reduced physical, sensory or mental capabilities or lack of experience and knowledge if they have supervision or instruction concerning use of the appliance in a safe way and understand the hazards involved.
- Children should not play with the appliance.
- For appliance with type Y attachment, if the supply cord is damaged, it must be replaced by the manufacturer, its service agent or similarly qualified person in order to avoid a hazard.

IMPORTANT SAFEGUARDS

- Do not place on or near a hot gas or electric burner, or in a heated oven.
- Appliances are not intended to be operated by an external timer or separate remote-control system.
- The container is designed for use with this appliance. It must never be used on a range top.
- Do not set a hot container on a wet or cold surface.
- Do not use a container with a loose or weakened handle or a cracked one.
- Do not clean container with cleaners, steel wool pads, or other abrasive material.
- WARNING: Risk of Fire or Electric Shock. Do not remove the bottom cover. No user serviceable parts inside. Repair should be done by authorized service personnel only.
- Avoid contacting moving parts.
- Check bean box for presence of foreign objects before using.

Model No.	GLDC12S110A
Power Consumption	120V, 60Hz
Watts	1000W
Capacity (water tank)	1.8 L
Capacity (bean box)	190 g

HOUSEHOLD USE ONLY
SAVE THESE INSTRUCTIONS

WHAT'S IN THE BOX

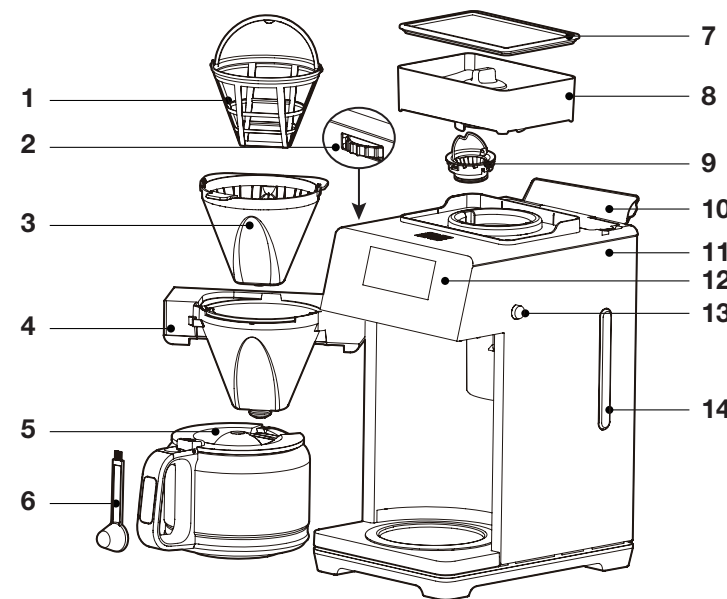

1. Reusable Filter:

Holds coffee grounds and can be washed after each use to be used again.

2. Grind Fineness Knob:

To adjust coarseness and/or fineness of the ground coffee.

3. Removable Filter Holder:

For placing reusable filter or paper filter.

4. Filter Basket:

Keeps the filter holder securely in place and filters coffee into the carafe.

5. Glass Carafe:

To hold coffee.

6. Measuring Scoop:

For measuring the amount of coffee grounds.

7. Bean box lid

8. Bean box:

6.5 oz. capacity

9. Grinder

10. Water Reservoir Lid:

To cover the water tank.

11. Water Reservoir:

To store the water.

12. Control Panel:

For operating the coffee maker and displaying the functions.

13. Filter Basket Holder button:

To open the filter holder.

14. Water Level Gauge:

To review the water volume.

GETTING TO KNOW YOUR COFFEE MAKER

CONTROL PANEL

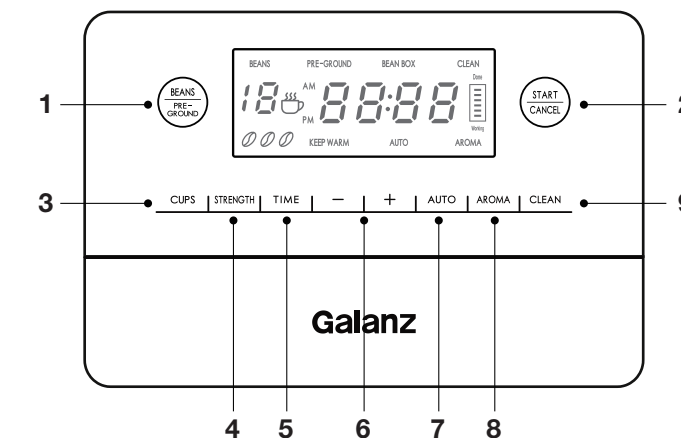

FUNCTION BUTTONS

1. BEANS/PRE-GROUND:

Use to select the brewing method of grinding fresh coffee beans or using pre-ground coffee.

"BEANS / PRE-GROUND" flashes when function is selected.

2. START/CANCEL:

Press to start the brewing process. Press again to cancel operation and return to standby mode.

3. CUPS:

To select the cups of coffee (2, 4, 6, 8, 10 or 12). "12" flashes when it is selected.

4. STRENGTH:

To select the strength of coffee. "000" flashes when it is selected: one bean means low concentration, two for middle concentration and three for high concentration.

5. TIME:

Press to adjust the time and press again to switch between hour and minute.

6. + / -:

To set the time.

7. AUTO:

To set a delayed start time. Once delayed start time is set "AUTO" will display.

8. AROMA:

Press to activate a unique brewing process that enhances the flavor and aroma of your coffee. Once AROMA is selected "AROMA" will display.

9. CLEAN:

We suggest running a cleaning cycle after 90 uses. "CLEAN" flashes when it is time to clean your coffee maker.

BEFORE FIRST USE

1. Remove all packaging material and stickers from the coffee maker.
2. Wash the water reservoir, carafe, filter, removable filter holder, and bean hopper in warm, soapy water with a soft cloth. Rinse parts and dry thoroughly.
3. Run 2 full standard brew cycles with 12 cups of water ONLY. After each cycle is complete, discard the water.

PROGRAMMING THE TIME

PROGRAMMING THE CLOCK(OPTIONAL)

- Press the **TIME** button once, and the number of hours will flash,
- Press **"+"** and **"-"** to adjust the time cycle (hold the **"+"** and **"-"** buttons to achieve continuous addition or subtraction); press the **TIME** button again, the number of hours stops flashing. The hour is confirmed and the number of minutes will be flashing at the same time.
- Press **"+"** and **"-"** to adjust the minute time; press **TIME** button again and the minute number stops flashing. The minute time is confirmed (if the time is not confirmed by pressing the button, it will automatically exit the time setting interface and save the setting after 10 seconds) and the display shows the current time. The **AM** or **PM** indicator will illuminate on the left side of the display as you are setting the time.

PROGRAMMING AUTO START (OPTIONAL)

- Press the **AUTO** button once, and the number of hours will flash.
- Press **"+"** and **"-"** to adjust the time cycle (hold the **"+"** and **"-"** buttons to achieve continuous addition and subtraction); press the **AUTO** button again, the number of hours will stop flashing. The hour is confirmed and the number of minutes will be flashing at the same time.
- Press **"+"** and **"-"** to adjust the minute time; press **AUTO** button again and the minute number will stop flashing. The minute time is confirmed. The **AUTO** light is on and entering the coffee brewing mode (if the time is not confirmed by pressing the button, it will automatically exit the time setting interface and save the setting after 10 seconds. The display of setting time will be exited while the display will show Current time). Press the **AUTO** button again, the light will go out and the delay brew mode will exit. During the process of presetting, you can directly press the **START/CANCEL** button to confirm or cancel the presetting.

BREWING WITH FRESH BEANS

1. SELECT THE AMOUNT OF CUPS

Press any button to wake up the machine. Press CUPS buttons to choose the desired amount the coffee to brew.

NOTE: You can choose 2/4/6/8/12 cups of coffee, and each cup of coffee takes 150ml of water to make.

2. FILL THE WATER RESERVOIR

Open the water reservoir lid and pour the desired amount of cold, preferably filtered water into the tank using a jug or the provided carafe.

NOTE: DO NOT fill pass the cup amount you selected otherwise the machine will brew all of the water you added and the coffee will become tasteless. If overfilled, pour out water until the level is no higher than the cup level you selected.

3. PUT THE BEANS INTO BEAN BOX

Fill the bean box with sufficient beans and close it.

NOTE: "BEAN BOX"will flash if the bean box is not closed properly and the **START/CANCEL** button is disabled. The machine will return to stand by mode if no action is taken after 20 minutes.

4. SELECT FUNCTION

Press **BEANS/PRE-GROUND** button to select **BEANS** function.

5. SELECT MODES

Press **STRENGTH/AROMA** button to choose your desired flavor.

6. START THE BREW CYCLE

Press the **START / CANCEL** button. The grinder will commence grinding the correct amount of coffee for the selected brew size and strength.

NOTE: Check the glass cup is in position before starting. During brewing cycle, all buttons are disabled excpet for **START/CANCEL** and **AROMA** button. Pressing the **START/CANCEL** button can temporarily stop the brewing cycle, and you can still adjust the flavor by pressing the **AROMA** button during brewing cycle.The progress bar will continously display indicating that the machine is working.

7. COMPLETE BREWING

When brewing completes the "KEEP WARM" will display. Now you can take the glass cup out and enjoy the coffee.

NOTE: Maximum keep warm time is 4 hours and "KEEP WARM" will keep displaying during this period. After that the machine exits keep warm mode and enters standby mode.

PREPARING & USING YOUR COFFEE MAKER

BREWING WITH PRE-GROUND COFFEE

1. FILL THE WATER RESERVOIR

Open the water reservoir lid and pour the desired amount of cold, preferably filtered water into the tank using a jug or the provided carafe.

NOTE: DO NOT fill past the cup amount you selected otherwise the machine will brew all of the water you added and the coffee will become tasteless. If over filled, pour out water until the level is no higher than the cup level you selected.

2. PUT THE COFFEE GROUNDS INTO THE FILTER

Press Filter Basket Holder button to open the swing-out door. Pour your desired amount of coffee grounds into the permeant filter holder or place a paper filter in the holder and add grounds to that. Close the filter basket holder.

NOTE: It is recommended to put 1 scoop of coffee grounds per 150ml water for the best flavor.

3. SELECT FUNCTION

Press **BEANS/PRE-GROUND** button to select **PRE-GROUND** function.

NOTE: CUPS and **STRENGTH** buttons are disabled and corresponding symbols do not display in **PRE-GROUND** mode.

4. SELECT MODES

Press **AROMA** button to choose your desired flavor.

NOTE: Press the **AROMA** button once and the icon will light up on the display screen, press it again to turn the **AROMA** mode off. The **AROMA** mode adjusts the heating tube to intermittently pulse and heat the coffee until the thermostat reaches the ideal warming state. This process prolongs the steeping time of the coffee grounds resulting in a more robust, even flavored cup of coffee.

5. START THE BREW CYCLE

Press the **START / CANCEL** button to start brewing.

NOTE: check the glass carafe is in position before start making coffee. Each time you press the **START/CANCEL** button, the heating tube will be signaled to start making coffee. Pressing it again will stop the current work. During the brewing process all the buttons except the **AROMA** are invalid. At the same time, the progress bar in the Done and Working icon will continuously scroll from bottom to top, indicating that the machine is working.

6. COMPLETE BREWING

When brewing completes “**KEEP WARM**” will display. Now you can take the glass carafe out and enjoy the coffee.

NOTE: Maximum keep warm time is 4 hours and “**KEEP WARM**” will keep displaying during this period. After that the machine exits keep warm mode and enters standby mode.

PREPARING & USING YOUR COFFEE MAKER

STATUS MESSAGES

1. "KEEP WARM" flashes in display:

When the brewing is done, the machine will enter keep warm mode by default and “**KEEP WARM**” flashes on display. Pressing **START/CANCEL** button can cancel keep warm mode and return to standby.

2. "BEAN BOX" flashes on display:

- ① Under **BEANS** mode if the bean box is not installed properly “**BEAN BOX**” will flash and **START/CANCEL** button is disabled.
- ② Under the **BEANS** mode, the machine only works when the **BEAN BOX** is in place and the “**START/CANCEL**” button is invalid.

3. "CLEAN" flashes on display:

After 90 times of brewing “**CLEAN**” will display to remind you to use the **CLEAN** function. Make sure the machine is not brewing and in standby mode, add 10 cups of water and a little vinegar into water reservoir, and press **CLEAN** button. Discard the remaining water when cleaning is done. Run another cycle with water only to make sure that all of the vinegar flavor is gone.

CARE & MAINTENANCE

This appliance requires little maintenance. It contains no user serviceable parts. Do not try to repair it yourself. Contact a qualified appliance repair technician if the product requires service.

CLEANING AFTER BREWING

CAUTION:Take the filter out and clean it after each use, otherwise the filter will **turn yellow** easily.

CAUTION: To protect against electrical shock, **DO NOT IMMERSE THE COFFEE MAKER IN WATER OR ANY OTHER LIQUIDS.**

CAUTION: DO NOT USE ABRASIVE CLEANERS OR METAL SCOURING PADS. Make sure to use only mild soapy water. Abrasive cleaners, scrubbing brushes and chemical cleaners will damage the coating on this unit. Pieces can break off and if they touch the electrical parts there could be a risk of electrical shock.

1.Your coffee maker should be cleaned regularly for best performance and longer life. Regular cleaning will also reduce the risk of fire hazard.

2.Remove plug from electrical outlet. Allow it to cool.

3.Clean the carafe with a damp, soapy cloth after each use. Make sure to use only mild soapy water.

4.Clean the filter basket with a dry, clean cloth after each use to prevent water drops from dripping into the glass cup or heat preserving plate.

5.Pour the residual coffee, rinse the filter and filter basket after each use. Wipe them dry before reinstalling to the coffee maker with dry, clean cloth.

6.If the grinder becomes clogged, remove the cover around the grinder to expose the grinder. Remove the grinder and clean it with a damp cloth to remove any stuck coffee pieces. Completely dry the grinder before reinstalling it.

7.Clean the outside of coffee maker with a damp cloth. Repeat with a dry, clean cloth.

8.Allow the appliance to cool and dry completely before storing. If storing the coffee maker for long periods of time, make sure that the coffee maker is clean and free of coffee beans or powder particles. Store the coffee maker in a dry location such as the table, countertop or cupboard shelf. Other than the recommended cleaning, no further user maintenance should be necessary.

9.Any other servicing should be performed by an authorized service representative.

STORAGE

Unplug the unit, cool and clean it before storing. Store the coffee maker in a clean, dry place. Never store appliance while it is hot or still plugged in. Never wrap cord tightly around the appliance. Do not put any stress on the cord where it enters the unit, as it could cause the cord to fray and break.

TROUBLE SHOOTING

BEAN BOX indication flashing
■ Check if the bean box is properly in place and turn the switch clockwise till you hear a click

Brewing does not start
■ Make sure there is water in the water reservoir
■ Make sure the carafe is in place. It will not dispense coffee if the carafe is not properly placed right under the brew basket, and the brewed coffee will remain in the brew basket which could lead to overflow.

Carafe Overflowed
■ Always ensure the carafe is completely empty before brewing.

Brew basket overflowed
■ Check first if the carafe is in place. If the carafe is in place but the brew basket is overflowed, the opening of the filter holder may be clogged. Take out the filter holder, rinse it and repeatedly press the valve till the clog is cleared.

Error code E1/E2/E3
■ Component failure inside the machine. It is not recommended to repair the machine on your own and please contact us at 1-800-562-0738 for troubleshootingand warranty support.

PRODUCT WARRANTY

This warranty applies to products sold by Galanz Americas in the U.S. This warranty is in lieu of any other warranty and expressly applies to the individual product only.

Galanz product is warrantied for one year following purchase for defects in material and workmanship. **Please save your receipt as proof of purchase is required to make a warranty claim.** During this warranty period, we will provide the replacement cost of this product, a replacement or the equivalent, or repair per our discretion.

The warranty cannot be transferred through resale, including the resale through a 3rd party unauthorized retailer and is only bestowed upon the original consumer purchaser upon purchase from an authorized retailer.

■ **This warranty does not cover and excludes damage or defects caused by:**

- Consumer misuse
- Abuse
- Neglect including the failure to clean and/or provide adequate regular maintenance as outlined in the user manual
- Commercial use
- Subjecting the product to any voltage outside the specified range
- Loss of parts
- The affixing of any attachments not provided with the product
- Accident, or
- Use in a manner not intended and outlined in the user manual.
- Any subsequent damages caused by the above listed exclusions will not be covered and any claims determined to meet the

- above exclusions will be denied. All liability is limited to the purchase price and does not include any:
- Retail offered extended warranties
 - Tax
 - Other charges(including postage to send required materials)
 - Incidental and/or consequential damages associated with the product in question.

Every implied warranty, including any statutory warranty of merchantability or fitness for a particular purpose is disclaimed except to the extent prohibited by law, in which case such warranty is limited to the duration of this written warranty. This warranty gives you specific legal rights. You may have other legal rights that vary depending on where you live. Some states do not allow limitations on implied warranties or special, incidental, or consequential damaged, so the above limitations may not apply to you.

If you have a claim under this warranty, please call our Customer Service number: 1-800-562-0738.

For faster service, please have the model number, serial number, and receipt ready for the operator to assist you.

WARRANTY REGISTRATION

Please mail this warranty card to address below within 30 days of purchase.

Galanz Americas, 55 Challenger Road, Suite 503, Ridgefield Park, NJ 07660.

PLEASE PRINT CLEARLY.

Name_____

Address_____

City_____State_____Postal Code_____

Phone_____Email_____

Model Number_____Serial Number_____

Purchase Location_____

You must attach a copy of your purchase receipt to validate your registration.