

Galanz

REFRIGERATOR INSTRUCTION MANUAL

Model No.:
GLR25M**R10

To ensure proper use of this appliance and for your safety, please read the following instructions completely before operating this appliance.

TABLE OF CONTENTS

Parts and features.....	1
Important safety instructions.....	1
Important grounding instructions.....	2
Installation instructions.....	3
Operation instructions.....	3
Cleaning.....	4
Defrosting.....	4
Power failure	5
Vacation.....	5
Moving the refrigerator.....	5
Specifications	6
Troubleshooting tips	6
Install the handles	8
Warranty.....	9

PARTS AND FEATURES

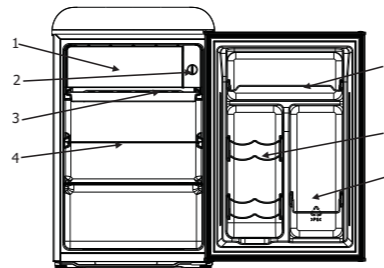

1. Freezer compartment
2. Temperature control dial
3. Drip tray
4. Removable shelf
5. Bottle storage
6. Can dispenser
7. Tall Bottle storage

IMPORTANT SAFETY INSTRUCTIONS

When using electrical appliances, basic safety precautions should always be followed to reduce the risk of fire, electrical shock, and/or injury to persons, including the following:

Read all instructions before using the appliance.

1. This appliance must be grounded. Connect only to properly grounded outlet. See Important Grounding Instructions on page 3.
2. Install or locate this refrigerator only in accordance with the provided Installation Instructions.
3. To protect against electric shock, do not place cord, plug, or refrigerator in water or other liquid.

4. Close supervision is necessary when any appliance is used by or near children.
5. Do not operate this appliance if it has a damaged cord or plug, if it is not working properly, or if it has been damaged or dropped.
6. This appliance should be serviced only by qualified service personnel. Contact your nearest authorized service facility or call our toll-free customer service number for information on examination, repair, or adjustment.
7. Do not cover or block any openings or air vents on this appliance.
8. Do not store this appliance outdoors. Do not use this appliance near water. For example, do not use near a kitchen sink, in a wet basement, near a swimming pool, or similar locations.
9. Do not locate this appliance near heat sources or open flames.
10. Do not use or store gasoline or other flammable vapors and liquid in the vicinity of this or any other appliance. The fumes can create a fire hazard or explosion.
11. Do not place heavy objects or magnet items on top of the refrigerator.
12. The refrigerant of this product is R600a, which is flammable. Make sure not to damage the cooling system during the transportation and installation.
13. To minimize the risk of possible ignition due to improper service or the use of incorrect parts, this unit must be serviced by factory authorized personnel only.

!!SAVE THESE INSTRUCTIONS!!

DANGER! RISK OF CHILD ENTRAPMENT

Before you throw away your old refrigerator or freezer:

1. Take off the doors.
2. Leave the shelves in place so that children may not easily climb inside.

Refrigerants

All refrigeration products contain refrigerants, which under federal law must be removed prior to product disposal. If you are getting rid of an old refrigeration product, check with a qualified disposal company for instructions.

IMPORTANT GROUNDING INSTRUCTIONS

This appliance must be grounded. In the event of an electrical short circuit, grounding reduces the risk of electric shock by providing an escape wire for the electric current. This appliance is equipped with a cord having a grounding wire with a grounding plug. The plug must be plugged into an outlet that is properly installed and grounded.

WARNING-Improper use of grounding can result in a risk of electric shock.

1. Consult a qualified electrician or serviceman if the grounding instructions are not completely understood or if doubt exists as to whether the appliance is properly grounded.

Three-pronged (grounding) plug



Properly polarized and grounded outlet

2. If it is necessary to use an extension cord, use only 3-wire extension cord that has a 3-blade grounding plug, and a 3-slot receptacle that will accept the plug on the appliance. The marked electrical rating of the extension cord shall be equal to or greater than the rating of the appliance.

INSTALLATION INSTRUCTIONS

1. Before using the refrigerator for the first time, remove all of the packing materials, including the foam base and adhesive tape holding accessories in place.
2. The refrigerator should be located on a firm, flat surface that is strong enough to support the refrigerator when it is fully loaded.
3. Choose a location that is not exposed to direct sunlight, high temperatures, heat sources such as a stove or radiator, or in a moist area. Do not choose a location where the temperature will go below 55°F as this could cause the refrigerator to not function properly.
4. Leave a minimum of 1/2" between each side of the appliance and the wall. The top and back of the appliance should have a minimum of 1 1/2" clearance. This allows for proper air circulation. This appliance is intended to be free-standing and should not be built-in or placed in a recessed area.
5. The refrigerator legs must be adjusted during installation in order to function properly. The leveling legs on the front corners can be adjusted by turning clockwise to raise the appliance, and counter-clockwise to lower it. Be sure to have the appliance slope slightly backward to ensure that the door closes tightly.

OPERATING INSTRUCTIONS

1. Allow refrigerator to stand upright for 4 hours before using.
2. Plug into a grounded outlet or appropriate extension cord (see Important Grounding Instructions).

3. The temperature of refrigerator can be controlled manually by the knob. Turn the knob to state COLD when it is normal used, turn it to the state during COLD-COLDEST if a lower interior temperature is required; contrarily, to the state during COLD-COOL, when a higher one is needed.

TEMP CONTROL



4. Food should be kept in sealed containers to prevent odors or drying.
5. Hot food should be cooled down before placing into the appliance to prevent increase in interior temperature and power consumption. Placing food inside too soon will impact the performance.
6. Reducing the frequency of door opening can lower power consumption.

CLEANING

Interior

Clean the interior of the appliance with a mixture of warm water and baking soda, using about 1-2 tablespoons per quart of water. Use a sponge or soft cloth and be sure to wring excess moisture out before cleaning around the controls. Rinse thoroughly with warm water and dry with a clean, soft cloth.

Exterior

The exterior surface can be cleaned using warm water and a mild detergent. Rinse thoroughly and dry with a clean, soft cloth.

Door Gasket

The door gasket must be kept clean to ensure a proper seal. Be sure to clean the gasket frequently, using the method described above.

DEFROSTING

Frost build-up on the walls of the freezer section will increase energy consumption and reduce the efficiency of the appliance. Defrost the freezer section whenever the frost reaches a thickness of 1/4".

1. Remove food from the refrigerator and freezer compartment.
2. If your model has a drip tray, be sure to place it under the freezer compartment to collect water, it may be necessary to empty the drip tray during the defrosting process.
3. Turn the unit off and unplug it from the outlet.

- The defrosting process can take several hours. Open the door to speed up the process.
- When defrosting is completed, wipe the compartment with a soft cloth to remove any remaining water.
- Reset the refrigerator temperature, following the operating instructions on page 4.

ATTENTION: Do not use sharp or pointed objects to remove frost or ice from the surfaces of the freezer compartment. This can cause damage to the compartment walls and cooling coils, and will void the warranty.

POWER FAILURE

When a power failure occurs, the refrigerator can normally store food for several hours. Do not put additional food into the appliance during a power failure, and do not open door. Disconnect the plug from the outlet, and reconnect when the power has been restored. **Always inspect for, and discard, any spoiled or thawed food in the refrigerator or freezer before resuming use of the appliance.**

VACATION

Before leaving on any vacation, remove food that could spoil while you are gone. If you plan to be for an extended period of time, we recommend that all of the food should be removed from the appliance and it should be turned off and unplugged from the outlet. Clean the interior according to the directions provided in the Cleaning section of this manual, and leave the door open.

MOVING THE REFRIGERATOR

- Turn off the refrigerator and unplug from the outlet.
- Remove all food and securely tape down all loose items inside.
- Tape the door shut.
- Do not lift or pull the door of door handle during transportation.
- When moving, the appliance can not be tilted over 45 degrees as possible damage to the sealed system could occur.
- Take care to avoid strong vibration or impact to the appliance.

SPECIFICATIONS

Climate	T	
Electric shock protection type	I	
Capacity (cu.ft)	2.5	
Voltage (VAC)	120	
Frequency (Hz)	60	
Current (A)	0.8	
Voice [dB(A)]	≤42	
Refrigerant	R600a/0.71oz	
Net weight	41.9lbs	
Interior temperature (F)	32~46.4	
Unit dimensions (in inches)	Width	17.60
	Depth	21.02
	Height	28.15

TROUBLESHOOTING TIPS

Problem	Possible Cause	What to do
Refrigerator does not operate	•Not plugged in tightly	•Unplug, wait 10 seconds, then plug in again
	•Tripped circuit breaker of blown fuse	•Replace fuse or reset circuit breaker
	•Problem with electrical outlet	•Consult with a professional electrician
Refrigerator seems too warm/food does not seem to cool	•Temperature setting may be too warm	•Lower the temperature setting
	•Door opened too frequently	•This is normal
	•Door not closed tightly	•Check to make sure nothing inside is causing the door to not close
	•Warm weather	•This is normal

Problem	Possible Cause	What to do
Compressor runs too long, or cycles on and off frequently	•Hot weather	•This is normal
	•Door opened too frequently	•This is normal
	•Door not closed tightly	•Check to be sure nothing inside the refrigerator is preventing the door from closing
	•Temperature control set at coldest setting	•Adjust temperature to a warmer setting
	•Large amounts of food placed in refrigerator	•This is normal
Moisture forms on the outside of the appliance	•This is normal during periods of high humidity	•Wipe the surface dry using a soft cloth
	•The door is slightly open	•Close the door tightly
Moisture forms on the inside of the appliance	•This is normal during periods of high humidity	•This is normal
	•Door is opened too long or too frequently	•Do not open the door too long or too frequently
Vibration noise	•Refrigerator is on an uneven surface	•Adjust the leveling legs
	•Refrigerator is touching a wall	•Move the refrigerator away from the wall

The following are normal conditions that can be encountered during the operation of this appliance:

- The flow of refrigerant through the coils can cause a noise.
- The sides of the appliance may become warm as a result of the cooling function.

INSTALL THE HANDLES

- Take out accessory from packing bags: two handles, two shake handle covers, and six screws.
- Prepare a cross screwdriver.



- Make sure the three screw holes in the shake hands are aligned with those in the door, and then respectively screw them together. The right side one is suggested to be preferred to be screwed down.

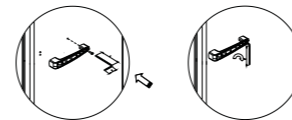

- Install handle cover on the handle. Tips for the Steps to Install:
 - Buckle the handle on the left side first.
 - Buckle the handle on the left side.
 - Buckle the middle part of the handle tightly in the end. And a click can be heard if the handle is properly installed.

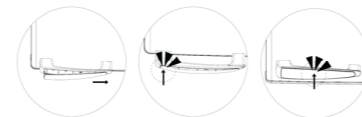

Product Warranty

This warranty applies to products sold by Galanz Americas in the U.S. This warranty is in lieu of any other warranty and expressly applies to the individual product only.

Galanz product is warrantied for one year following purchase for defects in material and workmanship. **Please save your receipt as proof of purchase is required to make a warranty claim.** During this period, we will provide the replacement cost of this product, a replacement or the equivalent, or repair per our discretion.

The warranty **cannot be transferred** through resale, including the resale through a 3rd party unauthorized retailer and is only bestowed up on the original consumer purchaser upon purchase from an authorized retailer.

This warranty does not cover and excludes damage or defects caused by:

- Consumer misuse
- Abuse
- Neglect including the failure to clean and/or provide adequate regular maintenance as outlined in the user manual
- Commercial use
- Subjecting the product to any voltage outside the specified range
- Loss of parts
- The affixing of any attachments not provided with the product
- Accident, or
- Use in a manner not intended and outlined in the user manual.

Any subsequent damages caused by the above listed exclusions will not be covered and any claims determined to meet the above exclusions will be denied. All liability is limited to the purchase price and does not include any:

- Retail offered extended warranties
- Tax
- Other change (including postage to send required materials)
- Incidental and/or consequential damages associated with the product in question.

Every implied warranty, including any statutory warranty of merchantability or fitness for a particular purpose is disclaimed except to the extent prohibited by law, in which case such warranty is limited to the duration of this written warranty. This warranty gives you specific legal rights. You may have other legal rights that vary depending on where you live. Some states do not allow limitations on implied warranties or special, incidental, or consequential damaged, so the above limitations may not apply to you.

If you have a claim under this warranty, please call our Customer Service number: **1-800-562-0738.**

For faster service, please have the **model** number, **serial** number, and **receipt** ready for the operator to assist you.